

SERIES 114T

PUMP MATERIALS

Pump Body: Nylon (black)
 Plunger: 304SS
 Seals: Proprietary Teflon blend
 Elastomers: Viton

Sprayer pump for applications up to 1.5 GPM, 200 PSI

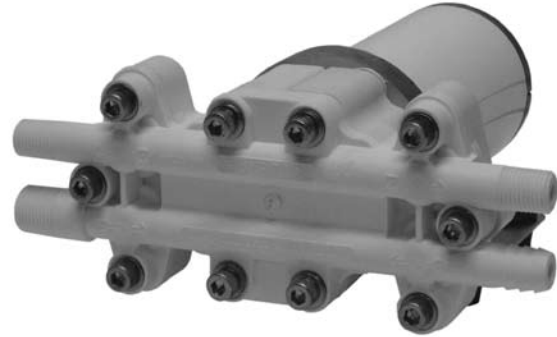

Available 4 port Polypropylene

SPECIFICATIONS

Flow: to 1.5 GPM
 Pressure: to 200 PSI
 Temperature: to 120°F
 RPM (max): 2400
 Inlet: 3/8 M NPT and 1/2 HB
 Outlet: 1/4 M(1), 1/4 F(2), 3/8 HB(1)

PN(Nylon)	MODEL	Flow	PSI	HP	AMP	Weight (lbs.)
80288	114T-075/M9	1.5	100	.08	9	8
80290	114T-075/M15	1.5	200	.15	15	10
80326	Spray Basic	1.5	200	.15	15	13

PN(Nylon)	MODEL	GPM	PSI	NOZZLE	AMP	Weight (lbs.)
80288	114T-075/M9	1.4	20	20	5.7	8
		1.25	30	15	6.2	8
		1.22	60	10	7.7	8
		1.2	90	8	9.6	8

PN(Nylon)	MODEL	GPM	PSI	NOZZLE	AMP	Weight (lbs.)
80290	114T-075/M15	1.4	20	20	4.6	10
		1.25	30	15	6.1	10
		1.22	60	10	7.7	10
		1.13	80	8	9	10
		1.06	125	6	10.6	10
		1.01	165	5	12.2	10
		0.95	225	4	14.3	10



Available 4 port horizontal

ph: 763.433.0303



Available 4 port vertical

toll free fax: 888.786.7832



Standard 6 port horizontal

pumpotec.com