

# WATERHORSE POWER Washer™ ACCESSORIES

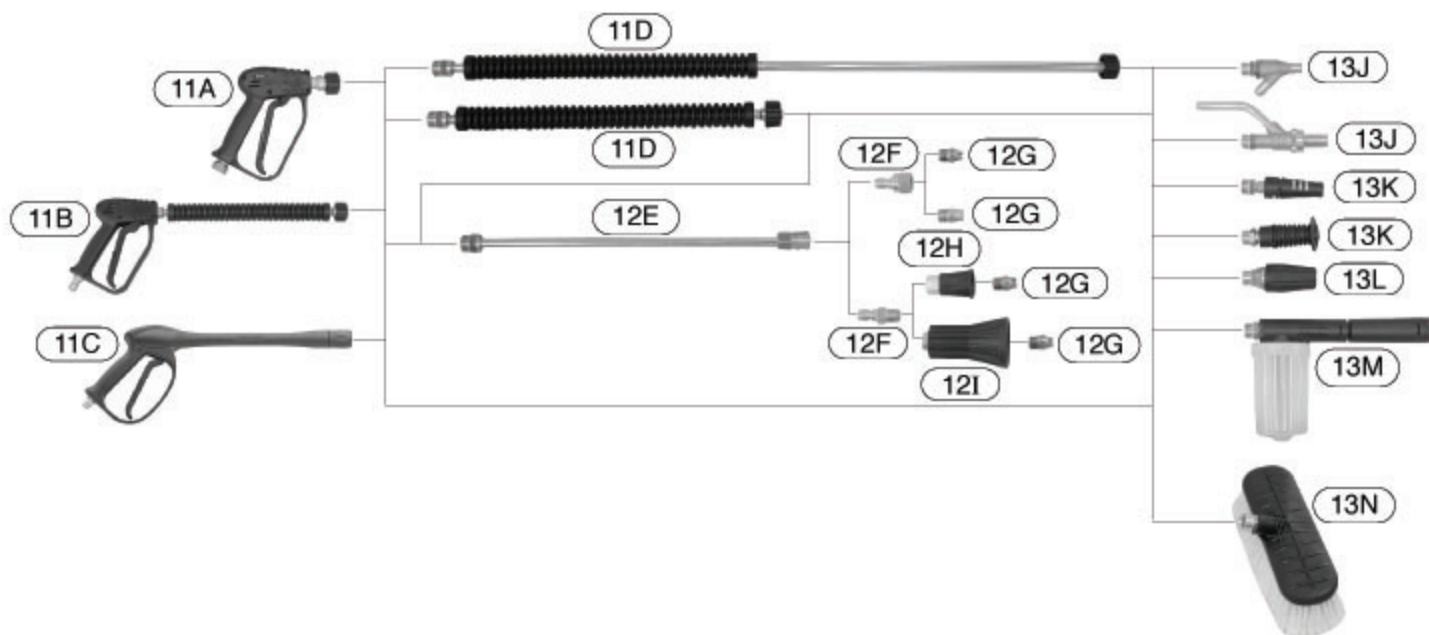

## SPRAY GUN, LANCE & NOZZLE ASSEMBLIES

Featuring: Spray Guns With Glass Filled Nylon Housing, Forged Brass Bodies, All Stainless Internals & Viton Seals, M22 Rotating Quick Connect Female Coupler Attaches To M22 Male Nipple On Extensions, Nozzles And Accessories.

11A



PART NUMBER	MAX PSI	MAX FLOW	SEALS	THREAD IN / OUT		LIST PRICE	WEIGHT EACH
920-RFC	4000	7	Viton	3/8 F	M22 FC	\$36.00	.5 lbs

11B



PART NUMBER	MAX PSI	MAX FLOW	BARREL LENGTH	SEALS	THREAD IN / OUT		LIST PRICE	WEIGHT EACH
920-RFC-LAN	4000	7	12	Viton	3/8 F	M22 FC	\$43.00	2.2 lbs

11C



PART NUMBER	MAX PSI	MAX FLOW	BARREL LENGTH	SEALS	THREAD IN / OUT		LIST PRICE	WEIGHT EACH
970-RFC	3200	7	12	Viton	1/4 M	M22 FC	\$33.00	.5 lbs

## INSULATED LANCE EXTENSIONS

Featuring: M22 Quick Connect Male Nipple Inlet & M22 Rotating Quick Connect Female Coupler Outlet.

11D



PART NUMBER	MAX PSI	DESCRIPTION	PORTS IN / OUT	LIST PRICE	WEIGHT EACH
LAN-18-INS-RQC	250	18" Lance Extension	M22 MN X M22 FC	\$16.00	1.5 lbs
LAN-36-INS-RQC	250	36" Lance Extension	M22 MN X M22 FC	\$23.00	2.0 lbs

\* PRICES SUBJECT TO CHANGE WITHOUT NOTICE \*

# WATERHORSE POWER Washer™ ACCESSORIES

## LANCE EXTENSION, NON-INSULATED ZINC PLATED STEEL

Featuring: M22 Quick Coupler Male Nipple Inlet, 1/4 Quick Coupler Socket Outlet.

12E



PART NUMBER	MAX PSI	DESCRIPTION	PORT	LIST PRICE	WEIGHT EACH
LAN-18-M22MNQC	250	18" Lance Extension	M22 MN X 1/4Socket	\$13.00	.3 lbs

## QUICK DISCONNECT PLUGS

Featuring: Heavy Duty Precision Machined Brass Plug. Adapts Lance 1/4 Quick Coupler Socket To Nozzles.

12F



PART NUMBER	MAX PSI	DESCRIPTION	PORT	LIST PRICE	WEIGHT EACH
QC-1/4 FP-B	2000	1/4 Plug, Brass	1/4 F	\$2.50	.3 lbs
QC-1/4 MP-B	2000	1/4 Plug, Brass	1/4 M	\$2.50	.2 lbs

## PREMIUM QUALITY HIGH PRESSURE NOZZLE

Featuring: Spraying Systems™ Hardened Stainless Steel Nozzle With Stream Straightener For Maximum Knife-Edge Efficiency. By Reducing The Impact Band Width By 1/2 You Effectively Double The Cleaning Pressure.

12G



PART NUMBER	MAX PSI	DESCRIPTION	THREAD SIZE	LIST PRICE	WEIGHT EACH
MEGSS-AA-XXX *	2000	MEG (HSS)	1/4 M	\$8.00	.2 lbs
VJB-8040	100	8040 VEEJET (Brass) soap nozzle	1/4 M	\$4.00	.2 lbs

\* Specify: AA=Angle, XXX=Orifice Size

## NOZZLE HOLDERS

Featuring: Rubber Protector Keeps Nozzle From Damaging Surfaces.

12H



PART NUMBER	MAX PSI	DESCRIPTION	PORTS IN / OUT	LIST PRICE	WEIGHT EACH
NH-1/4	3600	Pressure washer duty	1/4 F X 1/4 F	\$4.00	.2 lbs
NH-1/4HD	3600	Car wash duty	1/4 F X 1/4 F	\$6.00	.3 lbs

## NOZZLE HOLDER, HI/LOW ADJUSTABLE

Featuring: Adjustable Pressure Nozzle Holder Rotates To Low Pressure Setting For Chemical Application, Rotates To High Pressure For Rinse.

12I



PART NUMBER	MAX PSI	DESCRIPTION	PORTS IN / OUT	LIST PRICE	WEIGHT EACH
NH-ADJ	3000	Hi/Lo adjustable nozzle holder	1/4 F X 1/4 F	\$12.00	.5 lbs

\* PRICES SUBJECT TO CHANGE WITHOUT NOTICE \*

# WATERHORSE POWER Washer™ ACCESSORIES



## SAND BLASTING NOZZLES

Featuring: Light Duty Sand Blast Nozzle Can Also Be Used For Liquid Transfer. Professional Unit Features Carbide Sand Nozzle. M22 Male Nipple Inlet.

13J		PART NUMBER	MAX PSI	DESCRIPTION	INLET PORT	LIST PRICE	WEIGHT EACH
	1/2 B	SBN-30	2300	Light duty sand blasting head with liquid transfer feature	M22 MN	\$34.00	1.0 lbs
	1/2 B	SBN-33	3600	Professional sand blasting head with carbide sand nozzle	M22 MN	\$52.00	2.0 lbs

## VARIABLE NOZZLES

Featuring: Hi & Low Pressure Positions Click Forward For Low Pressure Chemical Application, Click Back For Hi Pressure Rinse, Rotate For 0° - 80° Fan Spray. M22 Male Nipple Inlet.

13K		PART NUMBER	MAX PSI	DESCRIPTION	INLET PORT	LIST PRICE	WEIGHT EACH
		IDRO-XXX-I	3000	Variable nozzle w/ instructions	M22 MN	\$25.00	.5 lbs
		IDRO-XXX-FP	3000	Variable nozzle w/ finger protection	M22 MN	\$25.00	.5 lbs

\* Specify: XXX=Orifice Size

## ROTATING NOZZLE

Featuring: Rotating Nozzle Directs 0° Spray Within A 25° Circular Pattern, Ideal Nozzle For Heavy Soil Removal. M22 Male Nipple Inlet.

13L		PART NUMBER	MAX PSI	DESCRIPTION	INLET PORT	LIST PRICE	WEIGHT EACH
		RN-2000-XXX *	2000	Rotating nozzle	M22 MN	\$25.00	1 lbs
		RN-3000-XXX *	3000	Rotating nozzle	M22 MN	\$60.00	1 lbs
		RN-4000-XXX *	4000	Rotating nozzle	M22 MN	\$80.00	1 lbs
		RN-5000-XXX *	5000	Rotating nozzle	M22 MN	\$150.00	2 lbs

\* Specify: XXX=Orifice Size

## FOAMER

Featuring: Adjustable Chemical Delivery Rate. M22 Male Nipple Inlet.

13M		PART NUMBER	MAX PSI	DESCRIPTION	INLET PORT	LIST PRICE	WEIGHT EACH
		FOAMER	1800	Foam dispenser	M22 MN	\$30.00	1.0 lbs

## BRUSH

Featuring: Soft Bristles, Ideal For Road Film Removal When Quick Connected To End Of Lance. Use With Chemical Injector For Foaming Brush Action. M22 Male Nipple Inlet.

13N		PART NUMBER	MAX PSI	DESCRIPTION	INLET PORT	LIST PRICE	WEIGHT EACH
		BRUSH-NYLON	70	Brush, nylon bristle	M22 MN	\$11.00	1.0 lbs
		BRUSH-HOG	70	Brush, hog bristle	M22 MN	\$55.00	2.0 lbs
		M22FC X 1/4M	3600	M22 Female Coupler	M22 FC X 1/4 M	\$6.00	.3 lbs
		M22FC X 1/4F	3600	M22 Female Coupler	M22 FC X 1/4 F	\$6.00	.3 lbs

\* PRICES SUBJECT TO CHANGE WITHOUT NOTICE \*

# WATERHORSE POWER Washer™ ACCESSORIES

## TEST GAUGE ASSEMBLIES

Featuring: Liquid Filled Industrial Grade Stainless Steel Pressure Gauges With Six Different Types Of Quick Connects.

14A



MODEL NUMBER	PSI RANGE	FACE DIAMETER	QUICK CONNECT TYPE	LIST PRICE	WEIGHT EACH
LFG-1000-3/8QC LFG-2000-3/8QC LFG-3000-3/8QC LFG-5000-3/8QC	0-1000 0-2000 0-3000 0-5000	2 1/2" 2 1/2" 2 1/2" 2 1/2"	3/8 Q.C. plug X 3/8 Q.C. socket	\$44.00	2 lbs
LFG-300-11/16MF LFG-600-11/16MF	+0-300 0-600	2 1/2" 2 1/2"	11/16 F nozzle thread X 11/16 M nozzle thread	\$36.00	2 lbs
LFG-600-1/4QC LFG-1000-1/4QC LFG-2000-1/4QC LFG-3000-1/4QC	0-600 0-1000 0-2000 0-3000	2 1/2" 2 1/2" 2 1/2" 2 1/2"	1/4 Q.C. socket X 1/4 Q.C. plug	\$42.00	2 lbs
LFG-300-1/4QCCV LFG-600-1/4QCCV LFG1000-1/4QCCV	0-300 0-600 0-1000	2 1/2" 2 1/2" 2 1/2"	1/4 Q.C. socket with check valve X 1/4 Q.C. plug with check valve	\$58.00	2 lbs
LFG-1000-M22MF LFG-2000-M22MF LFG-3000-M22MF	0-1000 0-2000 0-3000	2 1/2" 2 1/2" 2 1/2"	M22 Female Coupler X M22 Male Nipple	\$40.00	2 lbs
LFG-VAC-PSI-60	0-30" VAC 0-60 PSI Compound gauge	2 1/2"	3/4 M Garden hose X 3/4 F Garden hose swivel	\$38.00	2 lbs

## INJECTOR, HOSE AND FILTER ASSEMBLY

Featuring: Venturi Injector With Adjustable Chemical Metering Valve, Vinyl Suction Hose And Weighted Chemical Filter. 3/8 Q.C. Socket Inlet, 3/8 Q.C. Plug Outlet.

14B



MODEL NUMBER	ORIFICE DIAMETER	CHEM NOZZLE	RINSE NOZZLE	MAX PSI	MAX TEMP	MIN GPM	LIST PRICE	WEIGHT EACH
CHEM-INJ-1.6	1.6 mm	'40	'035	3200	200	1.6	\$39.00	3 lbs
CHEM-INJ-1.8	1.8 mm	'40	'035	3200	200	1.8	\$39.00	3 lbs
CHEM-INJ-2.1	2.1 mm	'40	'035	3200	200	2.1	\$39.00	3 lbs

\* PRICES SUBJECT TO CHANGE WITHOUT NOTICE \*