

357U SCHEMATIC

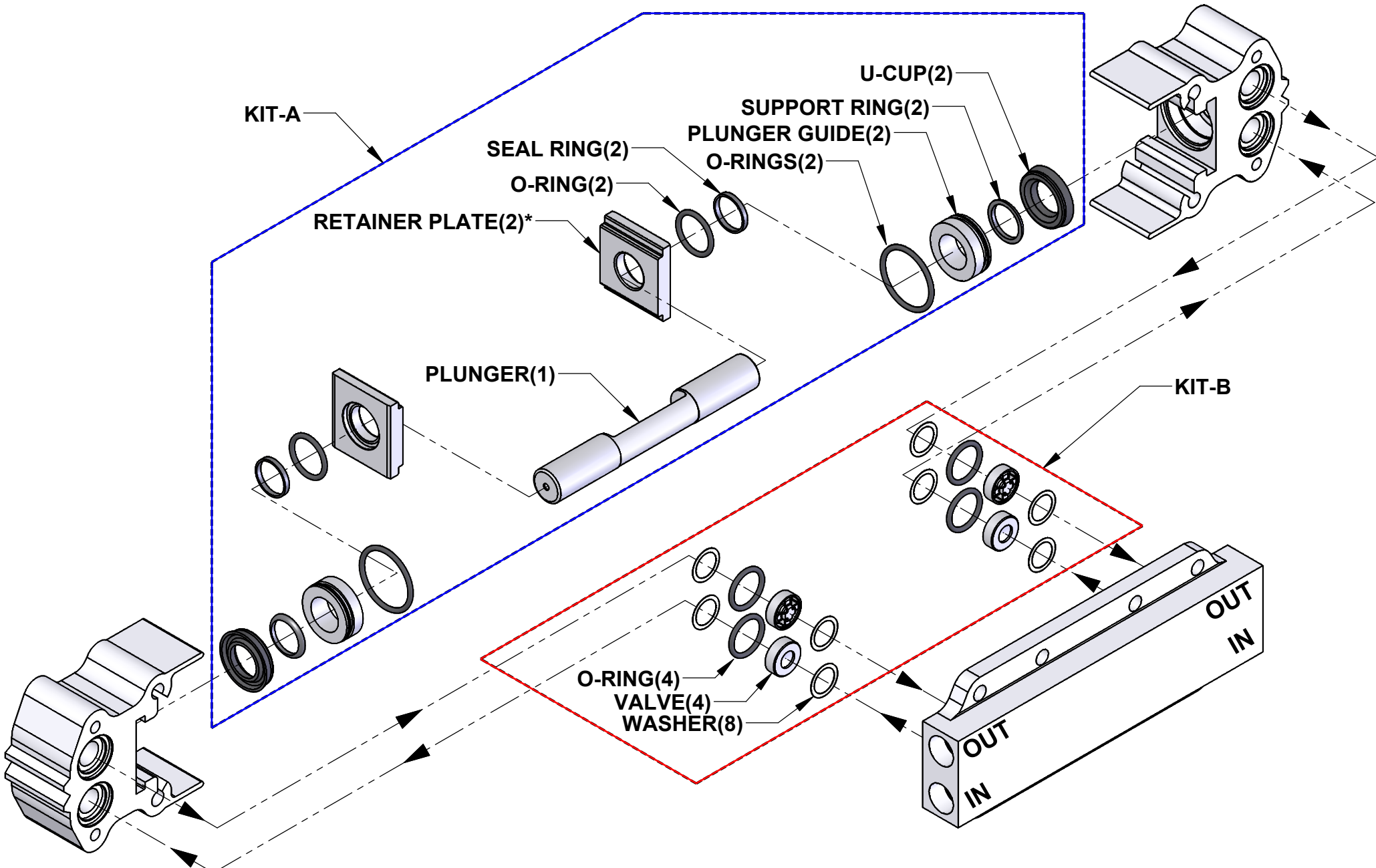

*NOT INCLUDED IN KIT-A

PART NUMBER DESCRIPTION

KIT-A

| | |
|---|---------------------------------------|
| 10013 | KIT-A, PLUNGER & SEALS, 348/357, BUNA |
| RETAINER PLATES NOT INCLUDED IN KIT-A. | |

KIT-B

| | |
|-------------------------------------|---|
| 10010 | KIT-B, VALVE & SEALS, 212/348/356/357, FOR S VALVES, BUNA |
| 10016 | KIT-B, VALVE & SEALS, 348/356/357, FOR H VALVES, VITON |
| BROWN O-RINGS INDICATE VITON | |
| BLACK O-RINGS INDICATE BUNA | |

PUMP WITH MOUNTING BOLTS.

| | |
|--|---|
| 60051 | 357U PUMP ONLY, BUNA, S-VALVE, 4 - 3/8" PORTS, BLACK |
| 60052 | 357U PUMP ONLY, VITON, H-VALVE, 4 - 1/2" PORTS, BLACK |
| CAM BEARING & MOTOR NOT INCLUDED. | |