

PUMPTEC

The Future In Pump Technology

Repair Instructions Series 112

Before disassembly:

- Make sure motor is disconnected from power source.
- Disconnect all plumbing.
- If the chemical pumped required bodily protection, this should be worn during repair as a residual amount will be present in pump and parts.

Disassembly:

- 1) Remove pump from motor.



- 2) Remove bolts from back of pump.



- 3) Lift manifold from pump.





**PUMPTEC's
Complete
Tool
Kit**
(3/16 Hex Wrench)



4) Pull heads apart.

5) Pull plunger from head.

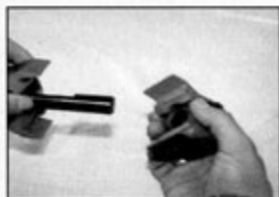

6) Remove retaining plate from each head. This part will normally fall out if head is tipped.



7) Guide and Seals can be removed with finger tips, or a non-abrasive or non-galling instrument. Do not use a screwdriver or a sharp metal tool.



8) Valves can be pushed out from below with the short end of hex wrench "tool kit".



Discard all worn parts and replace with new parts.

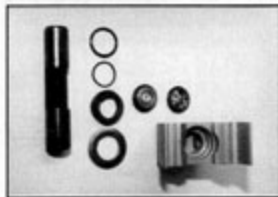

Clean head and manifold with a soft rag and soap to remove residual chemicals and grease.

1) Lightly grease O-ring and place seal ring inside.

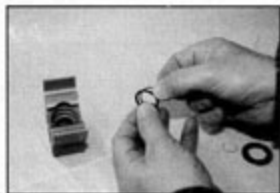

2) Slide guide1 onto plunger with taper facing end. Slide O-ring/seal ring assembly next to it. Slide guide2 from the opposite end, over slot, and behind guide1.

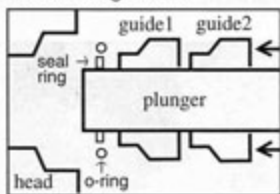

3) Push assembly into head by applying force to guide stack until it slides into place.



4) While holding guides in place, remove plunger.



5) Remove the guide just installed, and repeat on other head.

6) Slide retaining plate into slot with taper side toward seal retainer.



7) Install plunger into one head then press the other head assembly onto plunger.



8) Install one lightly greased white ring into each valve pocket in head.



9) Place one O-ring around each valve, and place assembly into valve pockets. Be careful to install valves in correct orientation.

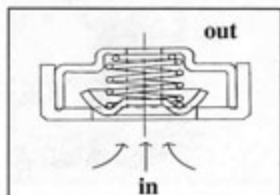

10) Install one lightly greased white ring into each valve pocket in manifold.



11) Place manifold on top of head/plunger assembly.



12) Adjust position of heads to match valve pockets in manifold. It will click into place.



13) Replace bolts with washers into back of pump and tighten finger tight.



14) Add a tablespoon of Moly EP grease to cam bearing and assemble pump to motor.



15) Rock and turn pump on end bell of motor to align pump to motor.



16) Tighten mounting bolts. Do not use excessive force because this may strip the bolt head or thread.



17) Tighten bolts on back of pump.

